



112 FINCHLEY ROAD
LONDON NW3 5HT
INFO@RHWESTATES.CO.UK
020 7431 7121

WWW.RHWESTATES.CO.UK



COMPAYNE GARDENS
SOUTH HAMPSTEAD
LONDON
NW6 3DN

PRICE: £1,900 PCM

FURNISHED

A stunning 1st floor 1 bedroom flat located in a very well maintain Victorian conversion only moments away from Finchley Road tube station and shopping facilities.

The apartment benefits from a spacious reception with original wooden floors, a split level open plan fitted kitchen, a great size bedroom with fitted wardrobe and a recent new bathroom.

The flat also has use of communal gardens and is available furnished



FEATURES:

- 1st Floor conversion
- Spacious reception
- Few minute walk to Finchley road Tube station
- Furnished
- Communal Gardens

First Floor

Approx. 38.3 sq. metres (412.1 sq. feet)

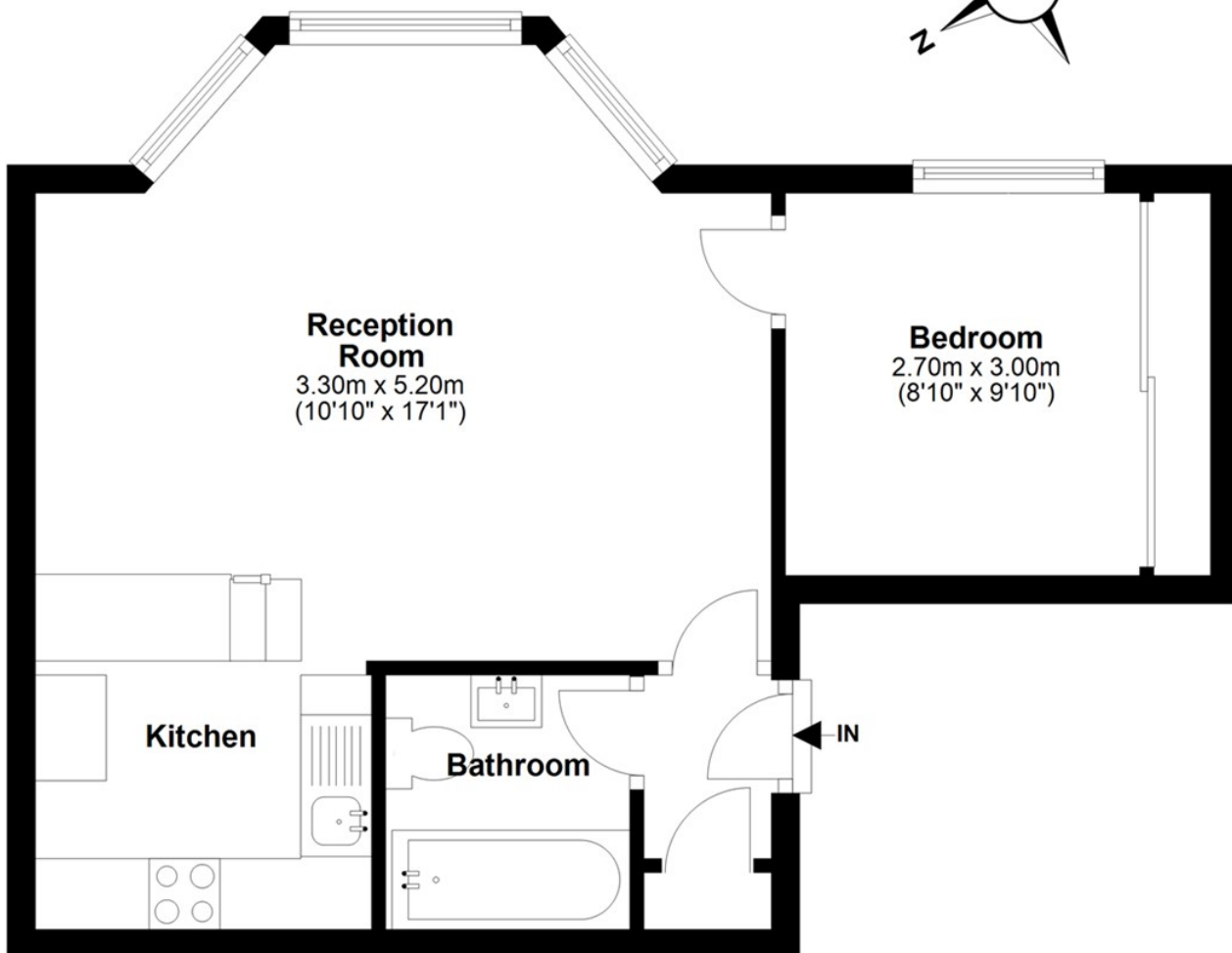

Total area: approx. 38.3 sq. metres (412.1 sq. feet)

Energy Efficiency Rating		
	Current	Potential
Very energy efficient - lower running costs		
(92 plus) A		
(81-91) B		
(69-80) C		
(55-68) D		
(39-54) E		
(21-38) F		
(1-20) G		
Not energy efficient - higher running costs		
England & Wales	EU Directive 2002/91/EC	

IMPORTANT NOTICE

Whilst every attempt has been made to ensure the accuracy of these details and floor plans contained here, measurements of doors, windows and rooms are approximate and no responsibility is taken for any error, omission or misstatement. These plans and details are for representation only as defined by RICS code of measuring practice and should be used as such by any prospective tenant. Not to scale. Copyright: RHW Estates

